

WWE380 WCS PWash&Steam&8kg

W1 front-loader washing machine:

A -40 %\* | 8 kg | 1400 rpm | SteamCare | QuickPowerWash | Miele@home



- Tested for 20 years of perfect laundry care\*
- Save even more energy with A -40 %\*\*
- SteamCare reduces ironing time by up to 50 % and freshens up your clothes
- QuickPowerWash ensures fast, efficient results in just 49 minutes\*\*\*
- Complete app control of your washing machine with Miele@home\*\*\*\*

\* During the development phase of the W1 washing machine series, Miele tested models and core components in 5000 wash loads (= 5 wash loads per week for 50 weeks per year) in various programmes. More: [miele.com/20years](http://miele.com/20years)

\*\* 40 % more economical than the threshold value (52) for energy efficiency class A.

\*\*\* This applies to all Miele washing machines that enable the process and machine-related parameters presented in the summary of the WL 1110/18 test report to be implemented.

\*\*\*\* Miele@home is a separate digital offer from Miele & Cie. KG. All smart applications are made possible with the Miele@home system. The range of functions can vary depending on the model and the country.



EAN: 4002516890577 / Material number: 12788190 /  
Old Material Number: 11WE3801GB

| Construction type  |                                 |
|--|---------------------------------|
| Suitable for stacking  | •                               |
| Side-by-side   | •                               |
| Slot-in  | •                               |
| Door hinge   | right                           |
| Model  |                                 |
| Product brand  | W1 White Edition                |
| Front-loader   | •                               |
| Spinning   |                                 |
| Max. spin speed  | 1400                            |
| Rinse hold   | •                               |
| Without spin function  | •                               |
| Design   |                                 |
| Appliance colour   | Lotus white                     |
| Control panel colour   | Lotus white                     |
| Door design  | Obsidian black with chrome ring |
| Rotary selector colour   | Lotus White / Chrome ring       |
| Control panel version  | 5° inclined                     |
| Control type   | Rotary control                  |
| Display  | DirectSensor white, 7 segment   |
| Cleaning performance   |                                 |
| Innovative PowerWash technology  | •                               |
| CapDosing portioned dispensing   | •                               |
| Gentle laundry care  |                                 |
| Honeycomb drum   | •                               |
| Load in kg   | 8.0                             |
| User convenience   |                                 |
| Networking with Miele@home   | •                               |
| Delay start up to 24 hours   | •                               |
| Time left display  | •                               |
| Programme sequence indicator   | •                               |
| AutoClean detergent drawer   | •                               |
| AddLoad  | •                               |
| Efficiency and sustainability  |                                 |
| Energy efficiency class (A–G)  | A                               |
| More economical than the threshold value (52) for energy efficiency class A    | 40%                             |
| Weighted energy consumption per 100 operating cycles for the wash cycle in kWh | 29                              |
| Weighted water consumption per cycle in l                                      | 48                              |
| Spin efficiency class (A–G)  | B                               |
| Acoustic airborne noise emission class (spin cycle; A–D)                       | A                               |
| Sound emissions during spin cycle in dB(A) re 1 pW                             | 68                              |
| Duration of the “ECO 40–60” programme at nominal capacity                      | 219                             |
| Power rating in off mode in W  | 0.40                            |
| Power rating in networked standby in W   | 0.80                            |

WWE380 WCS PWash&Steam&8kg

W1 front-loader washing machine:

A -40 %\* | 8 kg | 1400 rpm | SteamCare | QuickPowerWash | Miele@home



EAN: 4002516890577 / Material number: 12788190 /

Old Material Number: 11WE3801GB

|   |                     |
|---|---------------------|
| Low temperature wash "Cold" and "20 °C" | •                   |
| Automatic load control                  | •                   |
| Flow meter                              | •                   |
| Foam sensing                            | •                   |
| ProfiEco motor                          | •                   |
| <b>Wash programmes</b>                  |                     |
| QuickPowerWash                          | •                   |
| Cottons (coloureds)                     | •                   |
| Minimum iron                            | •                   |
| Delicates                               | •                   |
| Shirts                                  | •                   |
| Woollens (hand-washable)                | •                   |
| Express 20                              | •                   |
| Dark garments / Denim                   | •                   |
| Freshen up (steam)                      | •                   |
| Drain / Spin                            | •                   |
| ECO 40-60                               | •                   |
| <b>Washing extras</b>                   |                     |
| Short                                   | •                   |
| Pre-wash                                | •                   |
| Water plus                              | •                   |
| Additional rinse cycle                  | •                   |
| Pre-ironing with steam                  | •                   |
| Buzzer                                  | •                   |
| <b>Safety</b>                           |                     |
| Water protection system                 | Watercontrol-System |
| Safety lock                             | •                   |
| PIN-Code                                | •                   |
| Optical interface                       | •                   |
| <b>Technical data</b>                   |                     |
| Dimensions in mm (width)                | 596                 |
| Dimensions in mm (height)               | 850                 |
| Dimensions in mm (depth)                | 643                 |
| Appliance depth in mm with opened door  | 1077                |
| Weight in kg                            | 93                  |
| Total rated load in kW                  | 2.10-2.40           |
| Voltage in V                            | 220-240             |
| Fuse rating in A                        | 13                  |
| Frequency in Hz                         | 50                  |
| Length of supply lead in m              | 2                   |
| <b>Accessories included</b>             |                     |
| 3 Caps                                  | •                   |
| Voucher for Miele detergent             | •                   |

WWE380 WCS PWash&Steam&8kg

W1 front-loader washing machine:

A -40 %\* | 8 kg | 1400 rpm | SteamCare | QuickPowerWash | Miele@home

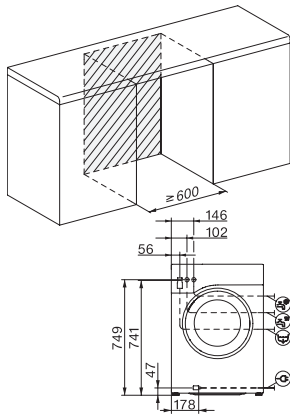

W1 drawing, facia 5 degree, measures in mm

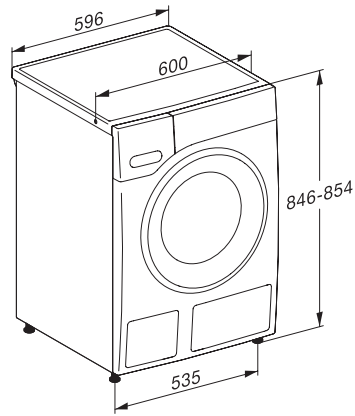

W1 drawing, facia 5 degree, measures in mm

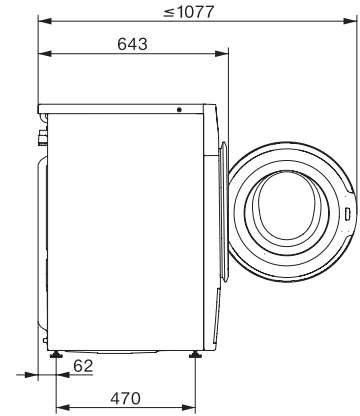

W1 drawing, facia 5 degree, measures in mm

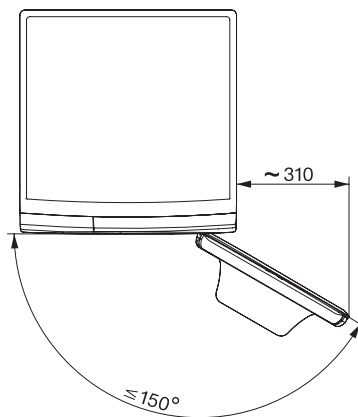

W1 drawing, facia 5 degree, measures in mm