

CSDA 7001 FL
SmartLine element
as downdraft extractor for extraction or recirculation operation



- Intuitive quick selection via number sequences – Smart Select
- Elegant design – for flush or raised installation
- Seamlessly integrates with any SmartLine element
- Efficient filtration- 10-ply stainless-steel grease filter
- Energy-efficient and quiet – powerful ECO motor

A++

EAN: 4002516304906 / Material number: 11402230 / Old Material Number: 27700150GB

Construction type	
Downdraft extractor	•
Operating modes	
Type of air guide	Convertible
Recirculation conversion kit (order separately)	DUU 1000-2
Flat ducting components (order separately)	DFK- xxxx
Design	
Flush	•
Frameless – surface-mounted	•
User convenience	
Operation via sensor controls	Smart Select
Digital power level display	•
Display colour	Yellow
Run-on time 5 min.	•
Efficiency and sustainability	
Energy efficiency class (A+++ to D)	A++
Annual energy consumption in kWh/year	25.3
Fluid dynamic efficiency class	A
Lighting efficiency class	-
Grease filtering efficiency class	B
ECO motor	•
Cleaning convenience	
Easy to clean ceramic glass	•
Easy-to-clean canopy interior – CleanCover	•
Filter system	
Number of dishwasher safe stainless-steel grease filters (10-ply)	1
Extraction	
Air throughput in Level 1 (m ³ /h) according to EN 61591	150
Air throughput in Level 2 (m ³ /h) according to EN 61591	290
Air throughput in Level 3 (m ³ /h) according to EN 61591	440
Sound power in Level 2 (dB(A) re 1 pW) according to EN 60704-3	58.0
Sound pressure in Level 1 (dB(A) re 20 µPa) according to EN 60704-2-13	29.0
Sound pressure in Level 2 (dB(A) re 20 µPa) according to EN 60704-2-13	43.0
Sound pressure in Level 3 (dB(A) re 20 µPa) according to EN 60704-2-13	51.0
Sound pressure in Booster level (dB(A) re 20 µPa) acc. to EN 60704-2-13	55.0
Recirculation	
Air throughput in Level 1 (m ³ /h) according to EN 61591	100
Air throughput in Level 2 (m ³ /h) according to EN 61591	235
Air throughput in Level 3 (m ³ /h) according to EN 61591	380
Air throughput in Booster level (m ³ /h) according to EN 61591	460
Sound power in Level 1 (dB(A) re 1 pW) according to EN 60704-3	49.0
Sound power in Level 2 (dB(A) re 1 pW) according to EN 60704-3	63.0

CSDA 7001 FL
SmartLine element
as downdraft extractor for extraction or recirculation operation



EAN: 4002516304906 / Material number: 11402230 / Old Material Number: 27700150GB

Sound power in Level 3 (dB(A) re 1 pW) according to EN 60704-3	73.0
Sound power in Booster level (dB(A) re 1 pW) acc. to EN 60704-3	78.0
Sound pressure in Level 1 (dB(A) re 20 µPa) according to EN 60704-2-13	34.0
Sound pressure in Level 2 (dB(A) re 20 µPa) according to EN 60704-2-13	49.0
Sound pressure in Level 3 (dB(A) re 20 µPa) according to EN 60704-2-13	58.0
Sound pressure in Booster level (dB(A) re 20 µPa) acc. to EN 60704-2-13	63.0
Safety	
Safety switch-off	•
FlameGuard	•
Technical data	
Dimensions in mm (width)	120
Dimensions in mm (height)	168
Casing height incl. connection box in mm	168
Dimensions in mm (depth)	520
Cutout dimensions in mm (width) with surface-mounted installation	100
Cutout dimensions in mm (depth) with surface-mounted installation	500
Inner cut-out dimensions in mm (width) with flush installation	100
Inner cut-out dimensions in mm (depth) with flush installation	500
Weight in kg	11
Outer cut-out dimensions in mm (width) with flush installation	124
Outer cut-out dimensions in mm (depth) with flush installation	524
Total rated load in kW	0.17
Voltage in V	230
Fuse rating in A	10
Length of supply lead in m	2
Number of phases	1
Installation notes	
Plinth fan with vent connection	•
Extraction connection at rear and side	•
Dimensions of the exhaust ducting connector in mm	222
Dimensions of the exhaust ducting connector in mm	89
Accessories supplied	
Ducting system to the plinth fan	•
Optional accessories	
Active charcoal filter	DKF 1000 R

CSDA 7001 FL
SmartLine element
as downdraft extractor for extraction or recirculation operation

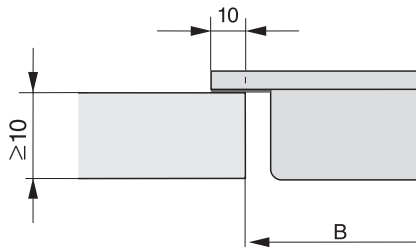

CS 7000 FL (Installation drawing)

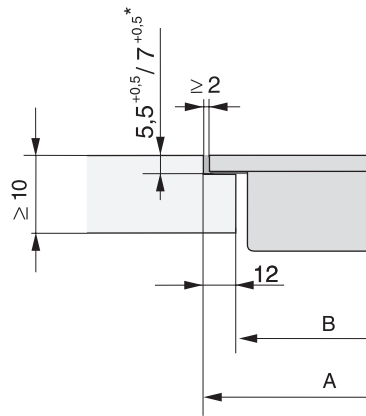

CS 7000 FL, flush (Installation drawing)

*7+0,5 = CS7611 (Wok)

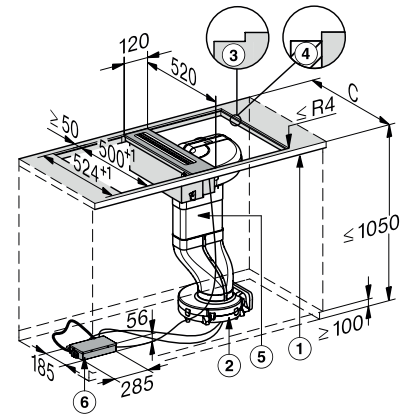

CSDA 7001 - flush (Installation drawing)

1) front, 2) Fan (in the plinth lying on the floor), 3) Stepped cut-out, 4) 12 mm wooden panel (not supplied as standard), 5) Air duct, 6) E-box

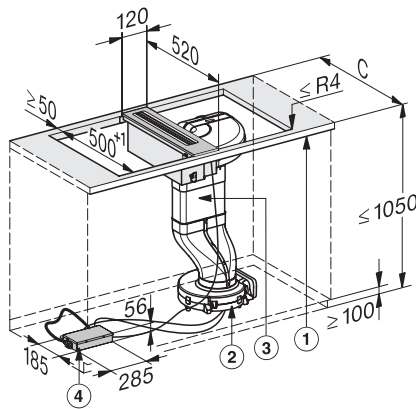

CSDA 7001 - supported installation (Skizze)

1) front, 2) Fan (in the plinth lying on the floor), 3) Air duct, 4) E-Box,

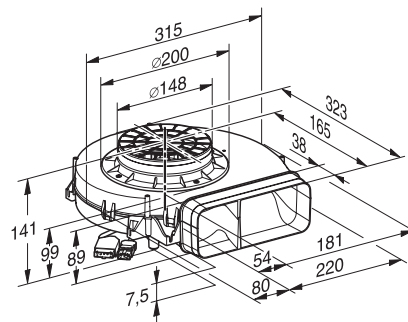

Plinth blower for CSDA 7001 (Installation drawing)